

S^o Carolina
 Pursuant to a warrant from John Thomas Esq^r Com^r of Locations
 N^o Saluda dated the 5th Nov^r 1793 I have admeasured and laid out unto
 Joseph Towles a tract of ninety acres of land (being part of a warrant of
 200 acres) in the County of Newburg on little River bounded N.E. on land
 granted to William Turner S.W. on land held John Mann N.W. & S.W. on
 land held by Joseph Towles and hath such Shape and Marks as the
 above plat Represents. — Surveyed the 10th November 1793

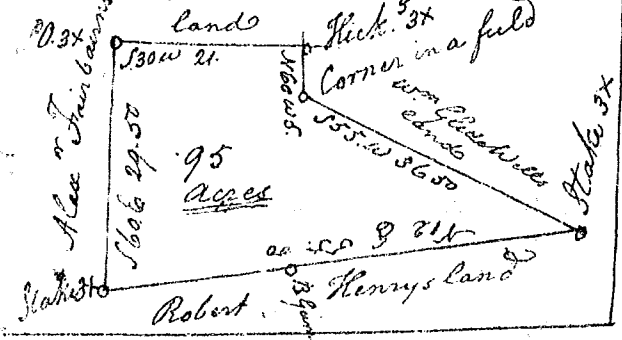

S^o Carolina Samuel Mays Esq^r
 Pursuant to a warrant from John
 Thomas Com^r of Locations N^o Saluda dated
 this day I have admeasured and laid out
 unto William Gladwell a tract of Ninety
 five acres of Land on a small branch of
 Duncans Creek in Laurens County bounding
 S.E. & S.W. on Alex^r Fairbanks Land N.W. & S.W.
 on Wm Gladwells Land S.E. on Robert
 Henrys Land and hath such Shape & Marks
 as the above plat Represents. —
 Surveyed the 13th Sept^r 1793.
 Robert Mays Esq^r

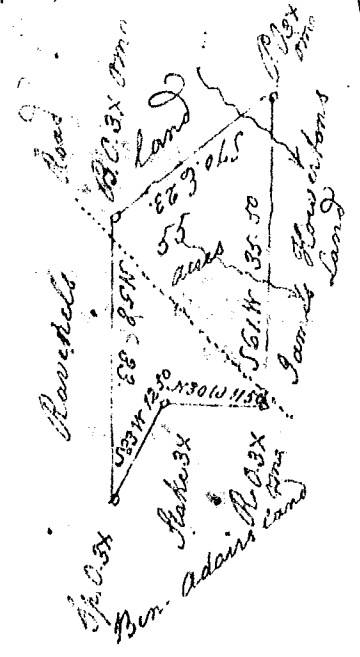

S^o Carolina
 Pursuant to a warrant from John
 Thomas Esq^r Com^r of Locations N^o Saluda